



NICK  **STEF'S**[®]
STEAKHOUSE

BAR

“BEST STEAKHOUSE IN DOWNTOWN LA” - *Downtown News*

CATERING AND SPECIAL EVENT SALES

P 213 972 3028 | F 213 972 3782 | events@nickandstefs.com
330 South Hope St. | Los Angeles, CA 90071 | patinacatering.com

TABLE OF CONTENTS

MAP	3
FOOD	4
COCKTAILS	5
FLIGHTS + MINI-PUNCHES	6
BEER	7
WATER	7
SPIRITS	8
WINES BY THE GLASS	11
CHAMPAGNE	12
CHARDONNAY	14
WHITE BURGUNDY	16
SAUVIGNON BLANC, LOIRE VALLEY WHITES AND ALTERNATIVE WHITES	17
PINOT NOIR	18
RED BURGUNDY	20
LE DOMAINE DE LA ROMANEE-CONTI	23
CABERNET SAUVIGNON AND MERITAGE	25
BORDEAUX	30
MERLOT	32
SYRAH, ZINFANDEL AND OTHER DOMESTIC VARIETALS	33
E. GUIGAL EXPRESSIONS OF TERROIR	35
RHONE VALLEY AND REST OF FRANCE	36
ITALY	37
SPAIN AND PORTUGAL	39
THE WINES FROM VEGA SICILIA	40
AUSTRALIA	40
TORBRECK'S VERTICALS AND HORIZONTALS	41
LATIN AMERICA	41
HALF BOTTLES, MAGNUMS AND LARGE FORMATS	42
DESSERT AND FORTIFIED WINES	44

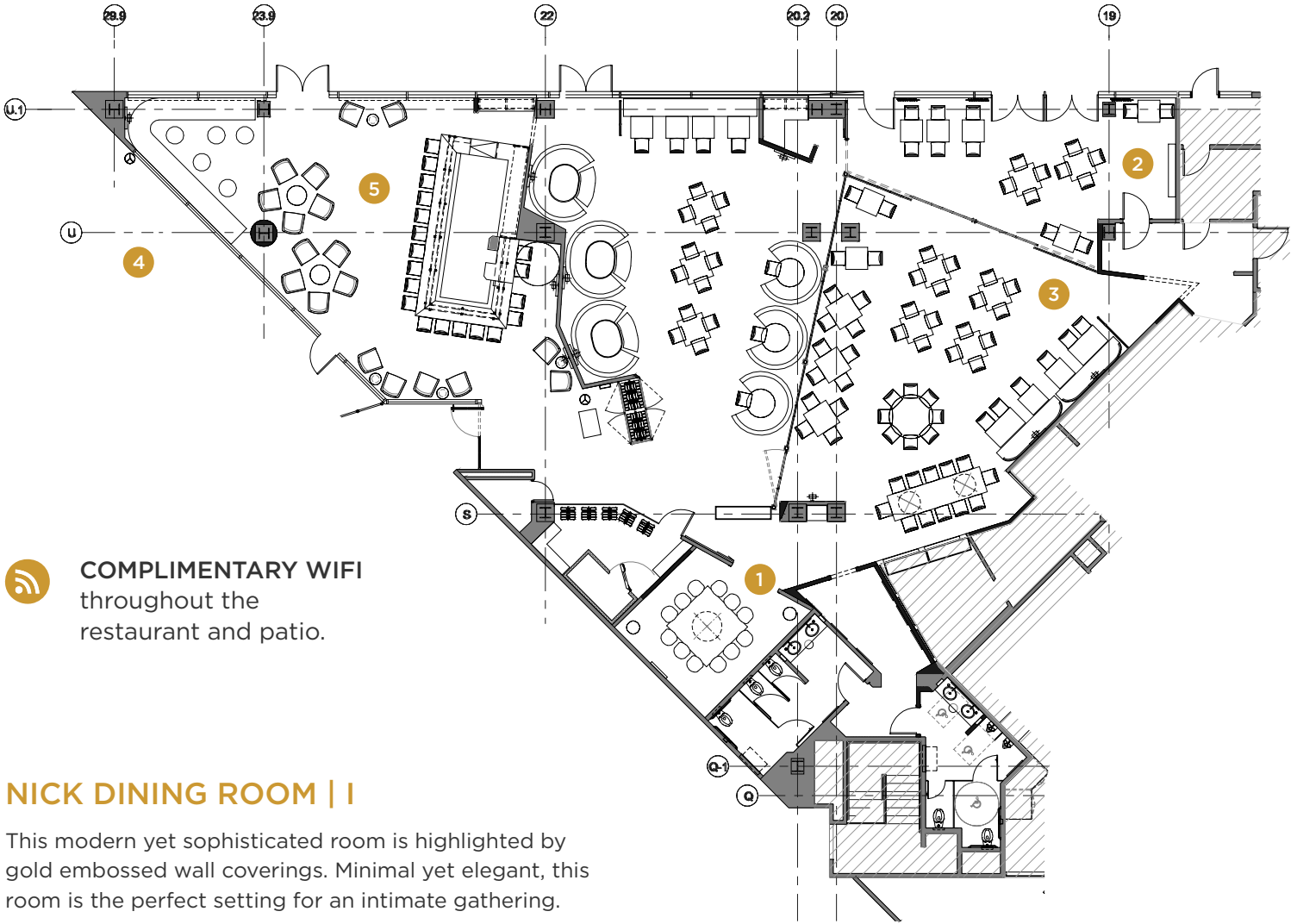

 **COMPLIMENTARY WIFI**
throughout the
restaurant and patio.

NICK DINING ROOM | 1

This modern yet sophisticated room is highlighted by gold embossed wall coverings. Minimal yet elegant, this room is the perfect setting for an intimate gathering.

SEATING CAPACITY: 12

STEF DINING ROOM | 2

The Stef Room is appointed with contemporary decor and is separated from the main restaurant by a frosted glass door for private occasions. Private patio available for pre-dining reception.

SEATING CAPACITY: 32 | A/V Equipped Room

J5 DINING ROOM 3

Dramatic and elegant, the J5 dining room is lined with richly upholstered banquettes and comfortable booths. This flexible and elegant space sets the tone for a large private dinner.

SEATING CAPACITY: 70

SEATING CAPACITY: 70 | 102 w/private dining room 2

PATIO | 4

Patio may be divided in three sections.

Dine among the energy of the city in the wraparound patio. Sheltered by uniquely designed umbrellas, the patio is set with inviting furnishing welcoming lingering conversations over cocktails and bites.

SEATING CAPACITY: 100

RECEPTION: 150

BAR | 5

Savor hand-crafted cocktails all surrounded by a rich elegant decor.

RECEPTION: 150

FOOD

TO SHARE

NICK AND STEF'S FRIES Hand-cut Russet fries, garlic, parsley 5

SWEET POTATO FRIES Ginger, cilantro 7

MIDDLE EASTERN MEZZE Fava, chickpea and eggplant purée, lebni, za'atar, mint 9

FRIED YUZU SESAME WINGS Free range chicken wings tossed in yuzu-sesame glaze 9

OYSTERS ON THE HALF SHELL Served with cocktail sauce and mignonette ½ dozen 18

SELECTION OF CHEESES Three or Five 15/22

OYSTERS *Served with cocktail sauce and mignonette.*

EASTERN	EACH	½ DOZ	DOZEN	PACIFIC	EACH	½ DOZ	DOZEN
Malpeque	3	15	30	Fanny Bay	3	15	30
Beausoleil	3	17	33	Kumiai	3	15	30
Misty Point	3	17	33	Kumamoto	4	22	40

SEAFOOD COCKTAILS AND APPETIZERS

BBQ GRILLED SHRIMP Madagascar 22

KING CRAB Alaska 24

LOBSTER Maine 26

N+S JUMBO LUMP CRAB CAKE Jumbo Maryland lump crab, cracker, creamy grain-mustard sauce, scallion purée 22

DIVER SCALLOP CRUDO Vegetable vinaigrette, togarashi 18

OYSTER & UNI SHOOTER Kumamoto oyster, sea urchin, sake, soy sauce, tobiko, daikon sprouts 16

SHELLFISH PLATTERS

NICK | 4 assorted oysters, 2 littleneck clams, 2 diver scallops, 4 jumbo Mexican white shrimp, 6 Prince Edward Island mussels, ½ Maine lobster, Serves 2 | 85

STEF | 9 assorted oysters, 4 littleneck clams, 4 diver scallops, 10 jumbo Mexican white shrimp, 12 Prince Edward Island mussels, ½ Maine lobster, 4 oz Dungeness crab, Serves 3-4 | 175

HAND CRAFTED COCKTAILS

OLD FASHIONEDS 13

CLASSIC OLD FASHIONED Builleit Bourbon, sugar, bitters, orange peel

SCOTCH OLD FASHIONED Famous Grouse Scotch, sugar, bitters, orange peel

COFFEE RUM FASHIONED Zaya 12yr Rum, coffee syrup, bitters, orange peel

OAXACAN OLD FASHIONED Partida Reposado Tequila, La Nina Del Mezcal, agave, orange peel

MANHATTANS 14

BOURBON MANHATTAN Builleit Bourbon, Carpano Antica, bitters

CYNAR TORONTO Rye, Cynar 70, simple, bitters

SOURS 13

TOKYO SOUR Kikori Japanese Whiskey, lemon, sugar, egg whites, yuzu bitters

NEW YORK SOUR Rye, lemon, sugar, egg whites, port wine, bitters

MARTINIS 14

NICK AND STEF'S MARTINI Plymouth Gin, dry vermouth blend, stirred, garnished with castelvetrano olive or lemon twist

REVERSE VESPER Ketel One Vodka, Plymouth Gin, Lillet Blanc, grapefruit peel

GIN & TONICS 12

ROSEMARY & LAVENDER Rosemary infused gin, lavender syrup, lemon, tonic

GRAPEFRUIT & CILANTRO Cilantro infused gin, grapefruit, lime, tonic

JALAPENO & CUCUMBER Jalapeno infused gin, muddled cucumber, lime, tonic

FLIGHTS + MINI-PUNCHES

FLIGHTS *(Flights of four 1 oz. pours)*

BOURBON 25

Bulleit 10yr, Knob Creek, Noah's Mill

SCOTCH 25

Bowmore 12yr, Auchentoshan 12yr, Laphroaig 10yr

SCOTCH 30

Glenfiddich 12yr, Balvenie 12yr, Balvenie 14yr Caribbean Cask

JAPANESE WHISKEY 35

Kikori, Nikka Coffey Grain, Nikka Yoichi 15

AMARO 20

Amaro Nonino, Margerum Amaro, Averna

MINI PUNCHES 28 *(Serves Two)*

LA SOUTHSIDE Absolut Elyx Vodka, Ancho Reyes, honey, lime, mint

EL DIABLO La Nina Del Mezcal, Olmeca Altos Blanco Tequila, crème de cassis, lime, ginger, soda

PENICILLIN Chivas 12yr Scotch, ginger, lemon, honey, float of Laphroaig

FRENCH 75 Plymouth Gin, sugar, lemon, Champagne

B E E R

B O T T L E S

Amstel Light 8
 Corona 8
 St Pauli (non-alcoholic) 7
 Sam Adams Lager 8
 Angry Orchard Cider 8
 Budweiser 8
 Bud Light 8
 Negro Modelo 8

D R A F T

Stella 8
 Chimay White 12
 Angel City IPA 9

W A T E R

Water is essential to life. Our curated water selection demonstrates the difference in taste between eight different waters from around the world. Their TDS levels (total dissolved solids of minerals including sodium, calcium, and magnesium) are determined by their terroir and characterize their flavor profiles, which assist in informing your water pairing choice.

S T I L L

ANTIPODES New Zealand 10	TDS 130 mg Sodium 10.6 mg Magnesium 1.7 mg Calcium 3.4 mg
ACQUA PANNA Italy 6	TDS 188 mg Sodium 7 mg Magnesium 7 mg Calcium 32 mg
FIJI Fiji 6	TDS 224mg Sodium 18 mg Magnesium 15 mg Calcium 18 mg
ISKILDE Denmark 7	TDS 426 mg Sodium 70 mg Magnesium 6.8 mg Calcium 63 mg

S P A R K L I N G

MOUNTAIN VALLEY SPRINGS

United States 6	TDS 220 mg Sodium 0 mg Magnesium 7.3 mg Calcium 74 mg
S.PELLEGRINO Italy 6	TDS 1109 mg Sodium 36 mg Magnesium 53 mg Calcium 181 mg
BADOIT France 7	TDS 1200 mg. Sodium 150 mg Magnesium 80 mg Calcium 153 mg
VICHY CATALAN Spain 7	TDS 3052 mg Sodium 1100 mg Magnesium 6.4 mg Calcium 14 mg

SPIRITS

VODKA

Aylesbury Duck, California	10
Absolut Elyx, Swedish	14
Belvedere, Poland	14
Grey Goose, France	14
Ketel One, Holland	12
Tito's, Texas	11

GIN

Tanqueray, England	11
Hendricks, Scotland	14
Beefeater, England	12
Fords Gin	11
Plymouth, USA	14
Oxley, England	16
Bombay Sapphire England	12

ARMANAC

Chateau De Laubade Bas Armagnac VSOP	17
Chateau De Laubade Bas Armagnac XO	34
Tariquet Classique VS Bas Armagnac	24

CALVADOS

Christian Drouin Coeur De Lion Selection	12
Christian Drouin Coeur De Lion VSOP	25

BRANDY

Clear Creek Pomme Eau-De-Vie, 8 Years Old	20
Encanto Pisco	12
Pisco Porton	14

COGNAC

Delamain Pale And Dry XO	32
Delamain Vesper	70
Delamain 1968	46
Chateau Fontpinot	36
Frapin VS	14
H By Hine VSOP	22
Hennessy XO	42
Hennessy Richard	132
Jean Fillioux, La Pouyade	17
Jean Fillioux, Tres Viux	27
Jean Fillioux, XO Reserve	34
Jean Fillioux, Reserve Familiale	42
Martell XO Supreme	39
Pierre Ferrand 1840	16
Rémy Martin VSOP	18
Rémy Martin XX	41
Rémy Martin Louis XXIII	75/oz

SPIRITS CON'T

SINGLE MALT SCOTCH

Auchentoshan, 12 years old	12
Balvenie, 15 years old	20
Bowmore, 15 year the darkest	24
Cragganmore, 12 years old	18
Cragganmore, 1992 distiller's edition	75
Dalmore, 12 years old	18
Highland Park, 12 years old	18
Highland Park, 18 years old	25
The Glenlivet, 12 years old	13
The Glenlivet, 15 years old	15
The Glenlivet, 18 years old	22
Glenfiddich, 12 years old	16
Glenfiddich, 15 years old	20
Glenfiddich, 18 years old	22
Glenmorangie, 10 years old	13
Isle of Jura, 10 years old	16
Lagavulin, 16 years old	25
Laphroaig, 10 years old	17
The Macallan, 12 years old	18
The Macallan, 18 years old	35
Oban, 14 years old	24
Talisker, 10 years old	17
Tomintoul, 16 years old	18
Tomintoul, 27 years old	42

BLENDED MALT SCOTCH

Chivas Regal 12 year	11
Chivas Regal 18 year	16
Chivas Regal 25 year	60
Compass Box Asyla	19
Cutty Sark	10
Dewar's White Label	12
Johnnie Walker Red	10
Johnnie Walker Black	12
Monkey Shoulder	10

IRISH WHISKEY

Bushmills Original	10
Kilbeggan	8
Jameson Original	12
Jameson Black Barrel	11
Tullamore Dew, 10 years old	20
The Tyrconnell	20
Redbreast	22

RYE WHISKEY

Bulleit	10
Hudson Manhattan	14
Knob Creek	14
Michter's US, 1-4 years old	13
Templeton Small Batch	12
Whistlepig, 10 years old	17

JAPANESE WHISKEY

Nikka Yoichi, 15 years old	39
Nikka Coffey Grain	22
Suntory Hibiki, 12 years old	26
Suntory Hakushu, 12 years old	42

DOMESTIC WHISKEY

Crown Royal	11
George Dickel No. 12	10
High West Silver Western Oat	14

SPIRITS CON'T

BOURBON

A.H. Hirsch Selection	10
Angel's Envy, 6 years old	13
Basil Hayden, 8 years old	13
Blanton's Single Barrel	18
Booker's	16
Buffalo Trace	10
Bulleit	10
Elijah Craig, 12 years old	12
Evan Williams Single Barrel	12
Four Roses Small Batch	12
Four Roses Single Barrel	16
Jefferson's Small Batch	16
Jefferson's Reserve	12
Hudson Baby Four Grains	12
Knob Creek, 9 years old	14
Woodford Reserve	14
Michter's	16
Noah's Mill, 15 year	18

WHITE RUM

Bacardi Heritage	9
Caña Brava Rum	10
Flor De Caña, 4 Years Old	8
Clément Canne Bleue	12

AMBER RUM

Appleton Estate Extra, 12 Years Old	14
Bacardi, 8 Years Old	10
Brugal 1888	16
Cruzan Single Barrel	12
Diplomático Reserva Exclusiva, 12 Years Old	16

DARK RUM

El Dorado, 15 Years Old	14
Gosling's Black Seal 151 Proof	10
Lost Spirits Navy Strength	12
Smith & Cross	8

TEQUILA BLANCO

Tequila Ocho	14
Fortaleza	13
Casa Dragones Joven	48
Partida	11
Cabeza Tequila	10

TEQUILA REPOSADO

Tequila Ocho	16
Fortaleza- Reposado	15
Partida	13
Don Julio	14

TEQUILA ANEJO

Partida	15
Tequila Ocho	20
Fortaleza	18
Don Julio 1942	55

MEZCAL / SOTOL

Del Maguey, Vida	14
Del Maguey, San Luis Del Rio	18
El Jolgorio, Espadin	16
El Jolgorio, Pechuga	24
Sotol Siempre	14

WINES BY THE GLASS

CHAMPAGNE AND SPARKLING

Patina Cuvée, France NV	10
Champagne, Ployes Jacquemart, Extra Quality Brut, Valee de la Marne NV	22
Nicolas Feuillatte Rose, Brut, Chouilly France NV	20

WHITE

Muscadet, Domaine Manard Gaboret, Loire Valley, France 2013	10
Albarino, Tablas de Sumar, Rias Baixas, Spain 2013	11
Sauvignon Blanc, Quincy, Domaine Adèle Rouzé, Loire Valley, France 2014	13
Pinot Grigio, Palmina, Honea Vineyard, Los Olivos, California 2014	11

CHARDONNAY

Chablis, Domaine Pinson Freres, Burgundy, France 2012	16
Patina Label, Au Bon Climat, Santa Barbara, California 2013	15
Chardonnay, Vega Sindoa, Navarra, Spain 2013	7/11
Chardonnay, Nicolas, Vin de Pays, France 2014	7/11

PINK

Miraval Jolie-Pitt & Perrin, Cote de Provance, France 2014	16
--	----

RED

Pinot Noir, Macphail, Sonoma Coast, California 2012	20
Pinot Noir, Transverse, Santa Rita Hills, California 2013	14
Barbera, Agostino Pavia, Blina, Piedmont, Italy 2103	13
Cabernet Sauvignon, Hall Estate, Napa Valley, California 2012	20
Cabernet Sauvignon, Obsidian Ridge, Red Hills, California 2012	17
Malbec, Comte John Du Monceau, Mendoza, Argentina 2012	14
Syrah, ONX, The Reckoning, Paso Robles, California 2013	15
Merlot, Vega Sindoa, Navarra, Spain 2013	7/11
Monastrel, Bodegas Volver, Tarima Hill, Alicante, Spain 2009	7/11
Cabernet Sauvignon, Domino, Delicato Vineyards, California 2013	7/11

FORTIFIED WINE

Sauternes, Chateau de Fargues, Bordeaux, France 2005	28
10 Year Tawny Port, Taylor Fladgate, Douro Valley, Portugal NV	14
20 Year Tawny Port, Taylor Fladgate, Douro Valley, Portugal NV	27
40 Year Tawny Port, Taylor Fladgate, Douro Valley, Portugal NV	42
Oloroso Sherry, Lustau, Almacenista, Jerez de la Frontera, Spain NV	17

BLANC DE BLANCS

1000	Besserat de Bellefon, Epernay, Cote des Blancs	NV	95
1001	J. Lasalle, Chigny-les-Roses, Montagne de Reims, Premier Cru	2004	105
1002	Lilbert, Brut, Cote des Blanc	2004	110
1003	Nicolas Feuillate, Cote des Blancs	2004	95
1004	Delamotte, Le Mensil sur Oger	2002	120

BRUT

1020	Grosset, Grand Reserve, Valee de la Marne	NV	110
1021	Chateau de Bligny, Cuvee six cepages, Bar sur Aube	NV	165
1022	Veuve Clicquot, Yellow Label, Reims	NV	110
1023	Nicolas Feuillate, Brut, Chouilly, Montagne de Reims	NV	95
1024	Billacart Salmon, Reserve, Montagne de Reims	NV	150
1025	Perrier Jouet, Nuit Blanches, Cote des Blancs	NV	100
1026	Godme, Blanc de Noir, Verzenay, Montagne de Reims, Grand Cru	NV	95

VINTAGE

1027	J. Lasalle, Cuvee Angeline, Montagne de Reims	2007	95
1028	Roederer, Cristal, Reims	2005	750
1029	Thienot, Cuvee Stanislas, Reims	2005	150
1030	Perrier Jouet, Belle Epoque, Cote des Blancs	2004	180
1031	Krug, Reims	2003	350
1032	Moet & Chandon, Dom Perignon, Cote des Blancs	2003	280
1033	Lanson, Gold Label, Reims	2002	90
1034	Devaux, Cuvee DD, Merry sur Arce	2000	110
1035	Roederer, Cristal, Reims	2000	385
1036	J. De Telmont Ordonnance Royal, Cote des Blancs	2000	195
1037	Krug, Reims	1998	350
1038	Nicolas Feuillate, Palme D'or, Cote des Blancs	1998	170
1039	Pommery, Cuvee Louise, Reims	1998	190
1040	Veuve Clicquot, La Grande Dame, Reims	1998	190
1041	Dom Ruinart, Reims	1998	150
1042	Roederer, Cristal, Reims	1990	999

ROSE

1060	Billecart, Salmon, Reims	NV	125
1061	Bruno Paillard, Reims, Premier Cru	NV	120
1062	Ruinart, Reims	NV	99
1063	Nicolas Feuillate, Brut, Chouilly, Cote des Blancs	NV	85
1064	Thienot, Reims	NV	99
1065	Bruno Paillard, Premier Cuvee, Reims	NV	280
1066	Perrier Jouet, Fleur de Champagne, Cote des Blancs	2002	375
1067	Camille Savès, Brut Grand Cru Rosé	NV	110

SPARKLING

1080	Le Vigne di Alice, Prosecco, Brut, Treviso, Italy	NV	60
1081	Jordan, J Cuvee, Russian River Valley, California	NV	75

1200	Les Lunes, Dobson Vineyard, Manton Valley, Tehama County	2014	56
1201	County Line, North Coast	2014	65
1203	Lompoc Wine CO, Estate Vineyard, Santa Rita Hills, Santa Barbara	2013	70
1204	Poseidon Vineyard, Carneros	2013	50
1205	Robert Craig, Gaps Crown Vineyard, Sonoma Coast	2013	75
1206	ZD, Napa Valley	2012	49
1207	Melville, Santa Rita Hills, Santa Barbara	2012	52
1208	Flora Springs, Estate Vineyard, Napa Valley	2012	45
1209	Kosta Brown, One Sixteen, Russian Rivery Valley	2012	100
1211	Jordan, Russian River Valley	2012	54
1212	Lewis Reserve, Napa Valley	2013	125
1213	Wenzlau Vineyard Estate, Santa Rita Hills, Santa Barbara	2011	75
1214	Krupp Brothers, Napa Valley	2011	95
1215	Garry Farrell, Russian River Valley, Sonoma	2011	65
1216	Hartford Court, Russian River Valley, Sonoma	2011	54
1217	Hyde de Villaine, Carneros	2011	90
1218	Talbott, Kali Hart, Monterrey	2010	39
1219	Chateau Montelena, Calistoga, Napa Valley	2010	75
1220	Hyde de Villaine, Carneros, Napa Valley	2009	80
1221	Lewis Reserve, Napa Valley	2009	100
1223	Marcassin, Three Sisters, Sonoma Coast	2008	220
1224	Kongsgaard, Hudson & Hyde Vineyards, Carneros	2000	220
1225	Au Bon Climat, Nuits - Blanches au Bouge, Santa Maria Valley	2005	95
1226	Au Bon Climat, Nuits - Blanches au Bouge, Santa Maria Valley	2004	95
1227	Au Bon Climat, Nuits - Blanches au Bouge, Santa Maria Valley	2003	95
1231	Kistler, Hudson Vineyard, Carneros	2012	150
1232	Kistler, Estate Vineyard, Sonoma Mountains	2011	150
1233	Kistler, Hudson Vineyard, Carneros	2011	150
1234	Kistler, Estate Vineyard, Sonoma Mountains	2010	180
1235	Kistler, Estate Vineyard, Sonoma Mountains	2013	150
1243	Kistler, Estate Vineyard, Sonoma Mountains	2009	150
1236	Kistler, Les Noisetiers, Sonoma Coast	2013	89
1238	Kistler, Vine Hill Vineyard, Russian River Valley	2011	175
1239	Kistler, Vine Hill Vineyard, Russian River Valley	2009	150
1241	Kistler, Hyde Vineyard, Carneros	2011	180

1245	Peter Michael, La Carriere Vineyard, Knights Valley	2009	145
1246	Peter Michael, Cuvee Indiginous, Knights Valley	2005	150
1247	Peter Michael, Mon Plaisir, Knights Valley	2001	145
1248	Peter Michael, Belle Cote Vineyard, Knights Valley	2001	125
1249	Staglin Family Vineyard, Salus, Rutherford, Napa Valley	2013	85
1252	Terrien, Hanzell Vineyard, Sonoma Valley	2009	75
1253	Terrien, Hanzell Vineyard, Sonoma Valley	2008	75
1256	Williams Selyem, Un-Oaked, Russian River Valley	2011	95
1257	Williams Selyem, Un-Oaked, Russian River Valley	2010	95
1258	Williams Selyem, Hawk Hill Vineyard, Russian River Valley	2000	100
1259	Williams Selyem, Heintz Vineyard, Russian River Valley	2001	100

CHABLIS

1401	Laurent Tribut	2013	65
1403	Domaine Laroche, Grand Cru, Les Clos	2009	150

COTE DE BEAUNE

1440	Montrachet, Joseph Drouhin, Marquis de Laguiche, Grand Cru	2005	750
1441	Savigny les Beaune, Domaine Leroy	2000	140
1442	Chevalier - Montrachet, Michel Niellon, Grand Cru	1998	300
1445	Chassagne - Montrachet, Ramonet, Premier Cru, Les Vergers	2000	135
1447	Chassagne - Montrachet, Colin-Deleger	2000	95
1448	Chassagne - Montrachet, Michel Niellon, Premier Cru, Les Chaumees	1999	110
1452	Corton - Charlemagne, Patrick Javillier, Grand Cru	2006	220
1453	Corton - Charlemagne, Domaine de la Vougeraie, Grand Cru	2005	265
1454	Corton - Charlemagne, Seguin Manuel, Grand Cru	2005	145
1456	Meursault, Marquis D'Angerville, Premier Cru, Santenots	2011	150
1457	Puligny - Montrachet, Jacques Prieur, Premier Cru, Les Combettes	2008	185
1458	Puligny - Montrachet, Jean Chartron, Premier Cru, Clos de Cailleret	2007	160

COTE DE NUITS

1470	Morey St Denis, Domaine Dujac, Premier Cru, Les Monts Luissants	2005	155
1471	Morey St Denis, Domaine Dujac, Premier Cru, Les Monts Luissants	2004	150
1472	Vougeot, Domaine de la Vougeraie, Premier Cru, Les Clos Blanc	2000	150

SAUVIGNON BLANC

17

1602	Dragonette, Vogelzang Vineyard, Happy Canyon	2013	75
1603	Duckhorn Vineyards, Napa Valley, California	2014	60
1604	Davis Bynum, Russian River Valley, California	2012	42
1605	Scholium Project, La Severita di Bruto, Farina Vineyard, Sonoma Mount	2012	85
1607	Quivera, Dry Creek, Sonoma	2011	35
1608	Hall, Napa Valley, California	2013	50
1610	Moraga Vineyard, Bel Air, California	2010	140
1611	Spottswoode, Napa Valley, California	2014	80
1609	Groth, Napa Valley, California	2013	60

LOIRE VALLEY WHITES

1702	Savennieres, Domaine du Closel, La Jalousie	2013	55
1703	Vouvray, Vincent Careme, Les Clos	2007	65

ALTERNATIVE WHITES

1800	Annia, Massican, Napa Valley, California	2014	65
1801	Chenin Blanc, Lieu Dit, Santa Ynez Valley	2014	50
1802	Pinot Gris, J Vineyard, Healdsburg, California	2013	38
1803	Pinot Grigio, Altanuta, Alto Adige, Italy	2012	35

ROSE

1902	Rose of Tibouren, Clos Cibonne, Cotes de Provence, France	2013	60
------	---	------	----

CENTRAL COAST

3001	Storm, Duvarita Vineyard, Santa Barbara	2013	90
3005	Talbott, Sleepy Hollow Vineyard, Santa Lucia Highlands	2013	55
3006	Peter Michael, Le Moulin Rouge, Pisoni Vineyard, Santa Lucia Highlands	2012	135
3018	Calera, Mills Vineyard, Mount Harla	2008	75
3008	Tantara, Evelyn, Santa Maria Valley	2007	130
3012	Peter Michael, Le Moulin Rouge, Pisoni Vineyard, Santa Lucia Highland	2000	135

RUSSIAN RIVER VALLEY

3050	Poco a Poco	2014	45
3052	Cirq, Tree House Vineyard	2011	125
3053	Martinelli, Bondi Home Ranch, Waterthrough Vineyard, Green Valley	2010	110
3054	Martinelli, Lolita Ranch	2010	110
3056	Williams Selyem	2013	120
3057	Williams Selyem, Calegari Vineyard	2012	120
3058	Williams Selyem, Foss Vineyard	2012	120
3059	Williams Selyem, Estate Vineyard	2012	210
3061	Williams Selyem, Westside Road Neighbors	2011	145
3062	Macphail, Sonoma Coast	2013	80
3063	Macphail, Sundawg Ridge	2012	110

SONOMA COAST

3080	Ceritas, Costalina	2013	96
3081	Radio - Coteau, La Neblina	2012	110
3083	Peter Michael, Le Caprice	2012	160
3084	Pahlmeyer	2010	130
3085	Cobb, Emmaline Anne Vineyard	2007	109
3086	Cobb, Joy Road Vineyard	2007	109
3087	Hartford Court, Far Coat Vineyard	2006	105
3088	Martinelli, Blue Slide Ridge	2001	120
3095	Kistler, Estate Vineyard	2012	180
3096	Kistler, Sonoma Coast	2011	145
3097	Kistler, Cuvee Catherine, Occidental Station Vineyard	2011	205
3099	Kistler, Estate Vineyard	2011	189
3101	Marcassin, Estate Vineyard	2007	269
3102	Marcassin, Estate Vineyard	2006	269
3104	Williams Selyem, Sonoma Coast	2011	100
3105	Williams Selyem, Sonoma Coast	2010	110
3106	Williams Selyem, Coastland Vineyard, Sonoma Coast	2002	120
3107	Williams Selyem, Coastland Vineyard, Sonoma Coast	2012	150

MENDOCINO

3140	Peay, Savoy Vineyard, Anderson Valley	2013	110
3141	Drew Family Cellars, Morning Dew Vineyard, Anderson Valley	2013	90
3142	Waits - Mast, Oppenlander Vineyard	2012	75
3143	Waits - Mast, Londer Vineyard, Anderson Valley	2011	60
3145	William Selyem, Wier Vineyard, Yorkville Highlands	2001	140
3146	Phillips Hill, Boontling, Anderson Valley	2013	55
3147	Phillips Hill, Cerise Vineyard, Anderson Valley	2012	95
3148	Phillips Hill, Oppenlander Vineyard	2012	85
3149	Phillips Hill, Oppenlander Vineyard	2005	115

WILLAMETTE VALLEY

3180	Erath, Dundee Hills	2013	45
3187	Beaux Freres, Belles Soeurs	2001	125
3188	Belle Pente, Estate Reserve, Yamhill - Carlton	2000	175
3189	Belle Pente, Estate Reserve, Yamhill - Carlton	2005	150
3190	Belle Pente, Estate Reserve, Yamhill - Carlton	2008	125
3191	Belle Pente, Murto Vineyard, Chehalem Mountain	2000	175
3192	Belle Pente, Murto Vineyard, Chehalem Mountain	2002	150
3193	Belle Pente, Murto Vineyard, Chehalem Mountain	2008	125

OTHER DOMESTIC PINOT NOIR

3108	Rusack, El Rancho Escondido, Santa Catalina Island	2012	120
3109	Kalin, Cuvee Billion, Sonoma County	1994	110

COTE DE NUITS

3301	Bonnes - Mares, Domaine Comte George de Vogue, Grand Cru	1998	260
3303	Chambertin, Domaine Pierre Damoy, Clos de Beze, Grand Cru	2009	275
3304	Chambertin, Domaine Pierre Damoy, Clos de Beze, Grand Cru	2008	275
3305	Chapel - Chambertin, Domaine Pierre Damoy, Grand Cru	2001	195
3306	Chambolle - Musigny, Sebastien Bideau, Les Herbues	2012	85
3307	Chambolle - Musigny, Phelippe Cheron, Les Quarente ouvrees	2011	120
3308	Chambolle - Musigny, Joseph Drouhin	2008	90
3309	Chambolle - Musigny, Domaine Hudelot Baillet	2005	90
3310	Chambolle - Musigny, JC Boisset	2004	95
3311	Chambolle - Musigny, Domaine Comte George de Vogue	2003	220
3312	Chambolle - Musigny, Domaine Comte George de Vogue	2000	230
3313	Chambolle - Musigny, George de Vogue, Amoureuses, Premier Cru	1998	265
3314	Chambolle - Musigny, George de Vogue, Amoureuses, Premier Cru	1997	265
3317	Clos de Vougeot, Phelippe Cheron, Grand Cru	2011	125
3318	Clos de Vougeot, Bouchard, Grand Cru	2004	270
3320	Clos de la Roche, JC Boisset, Grand Cru	2002	145
3322	Echezeaux, Rene Engel, Grand Cru	2001	200
3323	Echezeaux, Emmanuel Rouget	1999	195
3324	Fixin, Denis Mortet	2005	150
3325	Fixin, Denis Mortet	2004	135
3327	Gevrey - Chambertin, Denis Mortet, Vielle Vignes	2011	145
3328	Gevrey - Chambertin, Domaine Moillard	2010	69
3329	Gevrey - Chambertin, Rene Bouvier, Racines du Temp	2010	110
3330	Gevrey - Chambertin, Leroux	2010	99
3332	Gevrey - Chambertin, Denis Mortet, Vielle Vignes	2009	175
3333	Gevrey - Chambertin, Dugat Py, Coeur de Roy	2008	185
3334	Gevrey - Chambertin, Perrot Minot, Les Fontenys, Premier Cru	2007	180

COTE DE NUITS

3335	Gevrey - Chambertin, Denis Mortet, Mes Cinq Terroirs	2004	250
3336	Gevrey - Chambertin, Denis Mortet, Lavaux St-Jacques	1997	170
3337	Gevrey - Chambertin, Denis Mortet, En Champs	1997	153
3338	Marsannay, Denis Moret, Les Longeroies	2011	125
3339	Morey Saint Denis, Domaine Dujac	2008	125
3341	Marsannay, Denis Moret, Les Longeroies	2004	110
3343	Mazis - Chambertin, Domaine Maume, Grand Cru	1983	165
3346	Nuit Saint George, Domaine de la Vougeraie, Les Damodes	2010	125
3347	Nuit Saint George, Domaine Faiveley	2010	95
3348	Nuit Saint George, Benjamin Leroux, Les Allots	2010	125
3351	Nuit Saint George, J.F Mugnier, Clos Marechale, Premier Cru	2007	135
3352	Nuit Saint George, Comte Liger Belair, Aux Cras, Premier Cru	2006	240
3361	Vosne - Romanée, Gerard Mugnerert	2007	85
3366	Vosne - Romanée, Rene Engel	2004	120

COTE DE BEAUNE

3400	Beaune, Jean Claude Boisset, Greves, Premier Cru	2011	110
3401	Beaune, Louis Jadot, Clos des Ursules, Premier Cru	2011	110
3402	Beaune, Joseph Drouhin, Clos de Mouches, Premier Cru	2008	125
3403	Beaune, Domaine De Montille, Greves, Premier Cru	2006	100
3404	Chorey Les Beaune, Claude Marechal	2005	75
3405	Savigny Lavierres, Claude Marechal	2005	75
3406	Beaune, Camille Giroud, Les Bressenades, Primer Cru	1976	185
3407	Santenay - Maldieres, Domaine Prieur-Brunet, Premier Cru	2010	69
3409	Corton - Pouget, Louis Jadot, Grand Cru	2002	115
3410	Pommard, Francois Parent, Les Arvelets, Premier Cru	2011	180
3411	Pommard, Phillipe Pacalet	2010	125
3412	Claude Marechal, Les Chanieres	2005	170
3413	Pommard, Domaine de Courcel, Les Fremiers, Premier Cru	2002	110
3414	Pommard, Domaine de Courcel, Grand Clos de Epenots, Premier Cru	2002	115
3415	Savigny les Beaune, Simon Bize, Les Bourgeots	2012	125
3416	Savigny les Beaune, Simon Bize, Les Marconnets, Premier Cru	2011	125
3417	Savigny les Beaune, Simon Bize, Aux Guettes, Premier Cru	2011	125
3418	Savigny les Beaune, Simon Bize, Aux Vergelesses, Premier Cru	2011	120
3419	Savigny les Beaune, Domaine Denis	2009	65
3420	Savigny les Beaune, Mongeard Mugneret	2008	75
3421	Savigny les Beaune, Maison Leroy, Les Narbantons, Premier Cru	2007	850
3422	Savigny les Beaune, Emmanuel Rouget	2000	195
3423	Savigny les Beaune, Maison Leroy, Les Guettes, Premier Cru	1999	175
3424	Volnay, Nicolas Rossignol, Clos de Angles, Premier Cru	2009	80
3425	Volnay, Jacques Prieur, Clos de Santenots, Premier Cru	2009	165
3426	Volnay, Camille Giroud, Les Taillepieds, Premier Cru	2006	120
3427	Volnay, Michel Lafarge, Vendanges Selectionnees	2006	165
3428	Volnay, Arnaud Ente, Les Santenots du Milieu, Premier Cru	1998	160

3500	Échezeaux, Domaine de la Romanée - Conti, Grand Cru	2009	780
3501	Échezeaux, Domaine de la Romanée - Conti, Grand Cru	2006	610
3503	Échezeaux, Domaine de la Romanée - Conti, Grand Cru	2003	600
3504	Échezeaux, Domaine de la Romanée - Conti, Grand Cru	2002	510
3505	Échezeaux, Domaine de la Romanée - Conti, Grand Cru	2000	510
3506	Échezeaux, Domaine de la Romanée - Conti, Grand Cru	1997	680
3507	Grands Échezeaux, Domaine de la Romanée - Conti, Grand Cru	2000	620
3508	Grands Échezeaux, Domaine de la Romanée - Conti, Grand Cru	1998	490
3509	Grands Échezeaux, Domaine de la Romanée - Conti, Grand Cru	1998	490
3510	La Tâche, Domaine de la Romanée - Conti, Grand Cru	2011	2500
3511	La Tâche, Domaine de la Romanée - Conti, Grand Cru	2009	2200
3512	La Tâche, Domaine de la Romanée - Conti, Grand Cru	2008	2200
3513	La Tâche, Domaine de la Romanée - Conti, Grand Cru	2007	2100
3514	La Tâche, Domaine de la Romanée - Conti, Grand Cru	2006	2100
3515	La Tâche, Domaine de la Romanée - Conti, Grand Cru	2005	2500
3516	La Tâche, Domaine de la Romanée - Conti, Grand Cru	2004	1900
3517	La Tâche, Domaine de la Romanée - Conti, Grand Cru	2001	1800
3518	La Tâche, Domaine de la Romanée - Conti, Grand Cru	2000	2000
3519	La Tâche, Domaine de la Romanée - Conti, Grand Cru	1999	1900
3520	La Tâche, Domaine de la Romanée - Conti, Grand Cru	1998	1800
3521	La Tâche, Domaine de la Romanée - Conti, Grand Cru	1996	1800
3522	La Tâche, Domaine de la Romanée - Conti, Grand Cru	1995	1800
3523	Richebourg, Domaine de la Romanée - Conti, Grand Cru	2011	2250
3524	Richebourg, Domaine de la Romanée - Conti, Grand Cru	2010	2250
3525	Richebourg, Domaine de la Romanée - Conti, Grand Cru	2009	2250
3526	Richebourg, Domaine de la Romanée - Conti, Grand Cru	2008	2250
3527	Richebourg, Domaine de la Romanée - Conti, Grand Cru	2007	2250
3528	Richebourg, Domaine de la Romanée - Conti, Grand Cru	2006	2450
3529	Richebourg, Domaine de la Romanée - Conti, Grand Cru	2005	2750
3530	Richebourg, Domaine de la Romanée - Conti, Grand Cru	2004	2500
3531	Richebourg, Domaine de la Romanée - Conti, Grand Cru	2003	2150
3532	Richebourg, Domaine de la Romanée - Conti, Grand Cru	2002	2250
3533	Richebourg, Domaine de la Romanée - Conti, Grand Cru	2001	2400

3534	Richebourg, Domaine de la Romanée - Conti, Grand Cru	2000	2800
3535	Richebourg, Domaine de la Romanée - Conti, Grand Cru	1999	2600
3536	Richebourg, Domaine de la Romanée - Conti, Grand Cru	1998	2400
3537	Richebourg, Domaine de la Romanée - Conti, Grand Cru	1997	2400
3538	Richebourg, Domaine de la Romanée - Conti, Grand Cru	1996	2800
3539	Richebourg, Domaine de la Romanée - Conti, Grand Cru	1995	2800
3540	Richebourg, Domaine de la Romanée - Conti, Grand Cru	1993	2600
3541	Richebourg, Domaine de la Romanée - Conti, Grand Cru	1989	2700
3542	Romanée - Conti, Domaine de la Romanée - Conti, Grand Cru	2006	6000
3543	Romanée - Conti, Domaine de la Romanée - Conti, Grand Cru	2005	7500
3544	Romanée - Conti, Domaine de la Romanée - Conti, Grand Cru	2004	5000
3545	Romanée - Conti, Domaine de la Romanée - Conti, Grand Cru	2003	5000
3546	Romanée - Conti, Domaine de la Romanée - Conti, Grand Cru	2001	5000
3547	Romanée - Conti, Domaine de la Romanée - Conti, Grand Cru	1998	6000
3548	Romanée - Saint - Vivant, Domaine de la Romanée - Conti, Grand Cru	2012	2050
3549	Romanée - Saint - Vivant, Domaine de la Romanée - Conti, Grand Cru	2011	2050
3550	Romanée - Saint - Vivant, Domaine de la Romanée - Conti, Grand Cru	2010	2050
3551	Romanée - Saint - Vivant, Domaine de la Romanée - Conti, Grand Cru	2009	2050
3553	Romanée - Saint - Vivant, Domaine de la Romanée - Conti, Grand Cru	2007	1850
3554	Romanée - Saint - Vivant, Domaine de la Romanée - Conti, Grand Cru	2006	1850
3555	Romanée - Saint - Vivant, Domaine de la Romanée - Conti, Grand Cru	2005	2250
3556	Romanée - Saint - Vivant, Domaine de la Romanée - Conti, Grand Cru	2004	1850
3557	Romanée - Saint - Vivant, Domaine de la Romanée - Conti, Grand Cru	2003	1850
3558	Romanée - Saint - Vivant, Domaine de la Romanée - Conti, Grand Cru	2002	1150
3559	Romanée - Saint - Vivant, Domaine de la Romanée - Conti, Grand Cru	2001	1150
3560	Romanée - Saint - Vivant, Domaine de la Romanée - Conti, Grand Cru	2000	1350
3561	Romanée - Saint - Vivant, Domaine de la Romanée - Conti, Grand Cru	1999	1050
3562	Romanée - Saint - Vivant, Domaine de la Romanée - Conti, Grand Cru	1998	1050
3563	Romanée - Saint - Vivant, Domaine de la Romanée - Conti, Grand Cru	1996	950
3564	Romanée - Saint - Vivant, Domaine de la Romanée - Conti, Grand Cru	1995	1000
3565	Romanée - Saint - Vivant, Domaine de la Romanée - Conti, Grand Cru	1995	1150
3566	Vosne - Romanée, Domaine de la Romanée - Conti, Premier Cru	2009	790
3567	Vosne - Romanée, Domaine de la Romanée - Conti, Premier Cru	2006	760

NAPA VALLEY

4002	Robert Craig, Affinity	2012	180
4003	Stags Leap, Artemis	2012	150
4004	Continuum, Oakville	2011	225
4005	Lail, Blueprint	2011	95
4006	Joseph Phelps, Insignia	2011	295
4010	Tierra Roja Vineyard, Oakville	2011	186
4012	Bacchanal, Martin Estate, Rutherford	2011	75
4013	Vineyard 29 Estate	2010	190
4015	Almus, Cuvee Kemiji & Portay, Miura Vineyard, Pritchard Hill	2010	150
4016	Dominus Estate, Yountville	2010	270
4023	Heitz	2011	85
4019	Chappelet, Pritchard Hill	2010	185
4021	Mica, Bucella	2009	170
4022	The Mascot	2009	140
4017	Frank Family, Winston Hill, Rutherford	2009	175
4024	Joseph Phelps, Insignia	2009	275
4026	Rubicon	2009	285
4029	Merryvale, Profile, St. Helena	2009	250
4030	Checkerboard	2008	230
4032	Lokoya, Mount Veeder	2008	410
4033	Palmaz	2008	195
4034	Grassi Wine Company	2008	125
4042	Quintessa, Rutherford	2009	165
4035	Palmaz	2007	190
4036	Karl Lawrence, Herb Lamb Vineyard	2007	180
4038	White Cottage Ranch, Howell Mountain	2007	150
4039	Cain Five	2007	160
4040	Groth, Reserve	2007	185
4041	So Rare, Jon Nathaniel Wines, Rutherford	2007	120
4043	Robert Craig, Mount Veeder	2007	125
4044	Mayacamas Vineyard, Mount Veeder	2007	120
4047	Lokoya, Mount Veeder	2006	325
4028	Krupp Brother, Veraison	2009	120
4048	Mathiasson	2006	110
4049	Selene, Dead Fred Vineyard, Coombsville	2006	90
4051	Palmaz	2005	170
4052	Antinori Family Estate, Antica, Townsend Vineyard, Atlas Peak	2004	85
4054	Elyse, Morisoli, Rutherford	2003	90
4055	Kenefick Ranch, Calistoga	2002	110
4057	Emilio's Terrace, Schlein Vineyard, Oakville	2001	99

4059	Arietta	2001	160
4062	Richard Partridge, St Helena	2000	125
4063	Blankiet Estate, Paradise Hills Vineyard, Yountville	2000	200
4064	Hourglass Vineyard, St Helena	2000	165
4066	D.R Stephens	1999	125
4067	Carter Cellars Coliseum	1998	250
4109	Caymus, Special Select, Rutherford	1997	425
4069	Corison, Cronos Vineyard, St Helena	1996	126
4070	Abreu, Madrona Ranch, St Helena	2008	425
4072	Abreu, Madrona Ranch, St Helena	1999	375
4071	Abreu, Capella Vinyard, St Helena	1997	375
4079	Araujo, Eisele Vineyard, Calistoga	2010	525
4080	Araujo, Eisele Vineyard, Calistoga	2009	425
4081	Araujo, Eisele Vineyard, Calistoga	2007	420
4082	Araujo, Eisele Vineyard, Calistoga	2003	399
4084	Araujo, Eisele Vineyard, Calistoga	1999	325
4085	Araujo, Eisele Vineyard, Calistoga	1998	295
4100	Bryant Family, Pritchard Hill	2004	800
4102	Bryant Family, Pritchard Hill	2000	775
4103	Bryant Family, Pritchard Hill	1998	425
4110	Cardinale	2008	325
4111	Cardinale	2007	265
4112	Cardinale	2006	265
4113	Cardinale	2005	265
4115	Colgin, Cariad	2005	355
4118	Colgin, Cariad	2002	355
4119	Colgin, Cariad	2001	355
4120	Colgin, Cariad	2000	355
4121	Colgin, Cariad	1999	355
4123	Colgin, Herb Lamb Vineyard, St Helena	2003	355
4124	Colgin, Herb Lamb Vineyard, St Helena	1999	355
4125	Colgin, IX, Pritchard Hill	2008	450
4128	Colgin, IX, Pritchard Hill	2005	355
4129	Colgin, IX, Pritchard Hill	2004	355
4130	Colgin, IX, Pritchard Hill	2003	355
4131	Colgin, Tychson Hill Vineyard, St Helena	2004	355
4132	Colgin, Tychson Hill Vineyard, St Helena	2003	355
4133	Colgin, Tychson Hill Vineyard, St Helena	2000	355

4145	Dalle Valle, Collina, Oakville	2011	140
4148	Dalle Valle, Oakville	2009	275
4149	Dalle Valle, Oakville	2005	275
4150	Dalle Valle, Oakville	2002	225
4152	Dalle Valle, Oakville	1999	195
4153	Dalle Valle, Oakville	1998	198
4159	Diamond Creek, Gravelly Meadow, Diamond Mountain	2003	195
4161	Diamond Creek, Red Rock Terrace, Diamond Mountain	2003	195
4162	Diamond Creek, Red Rock Terrace, Diamond Mountain	2001	195
4163	Forman	2000	100
4164	Forman	1986	135
4165	Forman	1985	145
4166	Forman	1984	165
4167	Gemstone Vineyard, Yountville	2002	195
4169	Gemstone Vineyard, Yountville	2000	195
4170	Grace Family Vineyards, St Helena	2004	395
4173	Grace Family Vineyards, St Helena	2000	395
4174	Grace Family Vineyards, St Helena	1983	395
4180	Lewis Cellars, Mason's	2012	95
4181	Lewis Cellars, Reserve	2011	170
4182	Lewis Cellars, Reserve	2010	180
4183	Lewis Cellars, Reserve	2008	170
4184	Lewis Cellars, Reserve	1997	170
4185	Merus, Coombsville	2009	280
4186	Merus, Coombsville	2008	280
4190	Nickel & Nickel, Sullenger Vineyard, Oakville	2011	145
4191	Nickel & Nickel, Quarry Vineyard, Rutherford	2010	145
4192	Nickel & Nickel, State Ranch, Yountville	2010	145
4194	Opus One, Oakville	2010	290
4195	Opus One, Oakville	2009	290
4198	Opus One, Oakville	2004	310
4200	Opus One, Oakville	1985	600
4201	Pahlmeyer	2012	175
4202	Pahlmeyer	2009	175
4203	Pahlmeyer	1998	175
4204	Paul Hobbs	2011	150
4205	Paul Hobbs	2007	145
4206	Paul Hobbs, Beckstoffer, Oakville	2007	300

4207	Shafer, Hillside Select, Stags Leap	2010	325
4210	Shafer, Hillside Select, Stags Leap	1996	185
4211	Shafer, One Point Five, Stags Leap	2011	140
4212	Shafer, One Point Five, Stags Leap	2009	310
4215	Silver Oak	2009	150
4216	Silver Oak	2008	150
4218	Silver Oak	2006	150
4219	Spottswoode, Estate Vineyard, St Helena	2010	195
4220	Spottswoode, Estate Vineyard, St Helena	2009	190
4221	Spottswoode, Estate Vineyard, St Helena	1999	185
4223	Staglin Family Vineyard, salus, Rutherford	2011	150
4224	Staglin Family Vineyard, salus, Rutherford	2009	150
4225	Staglin Family Vineyard, Rutherford	2011	260
4226	Staglin Family Vineyard, Rutherford	2010	260
4227	Staglin Family Vineyard, Rutherford	2009	260
4228	Staglin Family Vineyard, Rutherford	2008	260
4229	Venge Family, Reserve, Oakville	2000	190
4230	Venge Family, Reserve, Oakville	1998	190
4231	Venge Family, Reserve, Oakville	1999	190

4502	Medlock Ames, Bell Mountain, Alexander Valley, Sonoma	2010	59
4504	Cenyth, Sonoma County	2009	99
4505	Leonetti, Walla Walla, Washington	2009	169
4508	Stonestreet Winery, Legacy, Alexander Valley, Sonoma	2006	120
4509	Anakota, Helena Dakota Vineyard, Knights Valley, Sonoma	2004	120
4511	Andrew Will, Ciel du Cheval Vineyard, Red Mountain, Washington	2007	250
4512	Andrew Will, Ciel du Cheval Vineyard, Red Mountain, Washington	2008	250
4513	Andrew Will, Ciel du Cheval Vineyard, Red Mountain, Washington	2009	250
4514	Andrew Will, Ciel du Cheval Vineyard, Red Mountain, Washington	2010	250
4515	Andrew Will, Champoux Vineyard, Horse Heaven Hills, Washington	2007	250
4516	Andrew Will, Champoux Vineyard, Horse Heaven Hills, Washington	2008	250
4517	Andrew Will, Champoux Vineyard, Horse Heaven Hills, Washington	2009	250
4519	Peter Michael, Les Pavots, Alexander Valley, Sonoma	2008	225
4520	Peter Michael, Les Pavots, Alexander Valley, Sonoma	2009	225
4521	Peter Michael, Les Pavots, Alexander Valley, Sonoma	2010	235
4522	Peter Michael, Les Pavots, Alexander Valley, Sonoma	2000	220
4523	Ridge, Montebello, Santa Cruz	1999	170
4524	Ridge, Montebello, Santa Cruz	1998	170
4503	Silver Oak, Alexander Valley, Sonoma	2010	105
4503	Silver Oak, Alexander Valley, Sonoma	2005	105
4503	Silver Oak, Alexander Valley, Sonoma	2004	105
4525	Moraga Vineyard, Bel Air	2008	180
4526	Moraga Vineyard, Bel Air	2007	180
4527	Moraga Vineyard, Bel Air	2005	180
4528	Moraga Vineyard, Bel Air	2000	195
4529	Moraga Vineyard, Bel Air	1998	190
4530	Moraga Vineyard, Bel Air	1997	210
4531	Moraga Vineyard, Bel Air	1996	180
4532	Moraga Vineyard, Bel Air	1995	180

POMEROL

5090	Chateau Petrus	2003	1250
5091	Chateau Petrus	2002	850
5092	Chateau Petrus	2001	850
5093	Chateau Petrus	1999	950
5094	Chateau Petrus	1992	900
5103	Chateau Plince	2000	125
5104	Chateau La Fleur Gazin	2005	125
5105	Chateau La Croix de Gay	2000	99
5106	Chateau La Conseillante	2000	229
5107	Chateau Beaugard	2000	159
5109	Chateau Latour a Pomerol	2007	174
5110	Chateau Latour a Pomerol	2002	154
5111	Chateau Latour a Pomerol	2001	155

ST EMILLION

5113	Chateau Cheval Blanc	2000	1100
5114	Chateau Pavie	2000	295
5115	Chateau Canon	2005	180
5116	Chateau Rol Valentine	2005	162
5117	Chateau Monbousquet	2005	162
5118	Chateau L'Angelus	2005	500
5119	Chateau La Gaffeliere	2005	195
5120	Chateau Quinault L'Enclos	2005	129
5121	Chateau Belair Monage	2004	129
5122	Chateau Belair Monage	2003	160
5123	Chateau Belair Monage	2002	115
5124	Chateau Monbousquet	2000	185
5125	Chateau Bellisle-Mondotte	2000	69
5126	Chateau Valandraud	1999	325

M E D O C

5001	Cotes de Francs, Chateau le Puy, Cuvee Barthelemy	2003	135
5002	Medoc, Chateau Pontesac	2000	110

G R A V E S

5003	Chateau Haut Brion	2000	1000
5004	Chateau Haut Brion	1982	1800
5006	Chateau Haut Brion	1966	425
5010	Domaine de Chevalier	2006	125
5011	Domaine de Chevalier	2005	125
5012	Chateau Pape Clement	2000	185
5013	La Chapelle de la Mission Haut Brion	2000	75

M A R G A U X

5020	Chateau Margaux	2003	325
5021	Chateau Margaux	2000	1000
5022	Chateau Margaux	1995	495
5030	Chateau du Margaux	2009	125
5031	Chateau Malescot St Exupery	2005	135
5032	Chateau Rauzan Segla	2005	170
5033	Chateau Boyd Cantenac	2005	99
5034	Chateau du Tertre	2004	125
5035	Chateau Rauzan Gassies	2000	85
5036	Chateau Palmer	2000	245
5037	Chateau Lascombes	2000	88
5038	Chateau D'Issan	2000	85
5039	Chateau Morojollia	1999	165

S T E S T E P H E

5040	Chateau Coutelin Merville	2009	79
5041	Chateau Le Crock	2008	82
5042	Chateau Cos D'Estournel	2000	349
5043	Chateau Lafon-Rochet	2000	79

PAUILLAC

5044	Chateau Lafite Rothschild	2000	1600
5045	Chateau Lafite Rothschild	1995	5000
5046	Chateau Lafite Rothschild	1946	8000
5047	Chateau Mouton Rothschild	2000	1000
5048	Chateau Mouton Rothschild	1979	1350
5049	Chateau Pichon Longueville Comtesse de Lalande	2005	275
5050	Chateau Pichon Longueville Comtesse de Lalande	2000	385
5051	Chateau Pichon Longueville Comtesse de Lalande	1995	385
5052	Chateau Pontet Canet	2005	165
5053	Chateau Grand Puy Lacoste	2005	160
5054	Chateau Lynch Bages	2005	185
5054	Chateau La Tourette'	2000	80

SAINT - JULIEN

5055	Chateau Talbot	2005	125
5056	Chateau Leoville Las Cases	2000	285
5057	Chateau Gloria	2000	75
5058	Clos du Marquis, Chateau Leoville Las Cases	2000	75
5059	La Croix de Beaucaillou	2000	65

MERLOT

7002	Truchard, Estate Vineyard, Los Carneros, California	2011	55
7003	Napa Cellars, Napa Valley, California	2011	45
7007	Grgich Hills, Estate Vineyard, Rutherford, Napa Valley, California	2009	75
7008	Thomas Fogarty, Santa Cruz Mountains, California	2008	42
7009	Andrew Will, Klipsun Vineyard, Red Mountain, Washington	2000	85
7010	Arietta, Hudson Vineyard, Napa Valley, California	1999	99
7011	Pahlmeyer, Napa Valley, California	2010	110
7012	Pahlmeyer, Napa Valley, California	2008	125
7013	Pahlmeyer, Napa Valley, California	2000	155
7014	Pahlmeyer, Napa Valley, California	1999	155
7016	Shafer, Napa Valley, California	2011	89
7015	Shafer, Napa Valley, California	2008	85

5200	Piedrasassi, Presqu'ile Vineyard, Santa Maria Valley	2012	80
5202	Cep, Sonoma Coast	2012	59
5204	Terre Rouge, Les Cotes de L'ouest, Sierra Foothills	2010	65
5205	Alban, Reva, Edna Valley	2009	125
5206	Amalie Robert, Willamette Valley, Oregon	2009	79
5208	Bonaccorsi, Bien Nacido Vineyard, Santa Maria Valley	2002	62
5209	Bonaccorsi, Red Monkey, Central Coast	2002	62
5211	Sine Qua Non, In Flagrate, Central Coast	2000	250
5212	Martinelli, Hop Barn Vineyard, Russian River Valley	2000	125
5216	Araujo, Eisle Vineyard, Calistoga	2009	195
5218	Colgin 9, Estate Vineyard, Pritchard Hill, Napa Valley	2007	325
5219	Colgin 9, Estate Vineyard, Pritchard Hill, Napa Valley	2006	325
5220	Colgin 9, Estate Vineyard, Pritchard Hill, Napa Valley	2004	265
5226	Copain, Eagle Point Ranch, Mendocino	2007	90
5227	Copain, Hawk Butte, Yorkville Highlands, Mendocino	2007	90
5228	Copain, Thompson Vineyard, Santa Barbara	2007	90
4229	Copain, Brosseau Vineyard, Chalone	2007	90
5222	Kongsgaard, Napa Valley	2005	195
5223	Kongsgaard, Napa Valley	2003	195
5224	Kongsgaard, Napa Valley	2002	195
5224	Kongsgaard, Napa Valley	2001	195
5225	Kongsgaard, Napa Valley	1999	195

5300	Poco a Poco, Porter Bass Vineyard, Russian River Valley	2013	45
5301	Bedrock, Old Vine	2013	50
5302	Robert Craig, Howell Mountain	2012	90
5303	Robert Biale Vineyards, Sonoma County	2012	95
5304	Hartford Court, Fanucchi Vineyard, Russian River Valley	2011	90
5305	Hartford Court, Russian River Valley	2010	69
5306	Dutton Goldfield, Sonoma	2008	72
5307	Storybrook, Exposure, Sonoma	2008	80
5308	Williams Selyem, Russian River Valley	2000	89
5309	The Terraces, Napa Valley	1999	65
5310	Martinelli, Jackass Vineyard, Russian River Valley	2011	120
5311	Martinelli, Jackass Vineyard, Russian River Valley	2000	105
5312	Martinelli, Giuseppe & Luisa, Russian River Valley	2001	90
5313	Martinelli, Jackass Vineyard, Russian River Valley	2001	90
5315	Turley, Duarte Vineyard, Contra Costa County	2001	82
5316	Turley, Estate Vineyard, Napa Valley	2013	92

OTHER DOMESTIC VARIETALS & BLENDS

5351	Gamay Noir, Arnot - Roberts, El Dorado County	2013	75
5352	Grenache, A Tribute to Grace, Santa Barbara County	2012	49
5353	Stags Leap, The Investor	2012	90
5354	Cabernet Franc, Jonata, El Alma	2011	140
5355	Le Cigare Volant, Boony Doom, Santa Cruz	2011	99
5359	Espirit du Beucastel, Tablas Creek, Paso Robles	2009	90
5360	Petite Sirah, Turley, Estate Vineyard, Napa Valley	2003	180
5361	Petite Sirah, Turley, Hayne Vineyard, Napa Valley	2003	180
5362	Petite Sirah, Turley, Rattlesnake Ridge, Howell Mountain	2003	180

E. GUIGAL'S EXPRESSIONS OF TERROIR FROM CÔTE RÔTIE

5400	La Mouline	2010	775
5401	La Mouline	2009	725
5402	La Mouline	2008	590
5403	La Mouline	2006	590
5404	La Turquie	2011	650
5405	La Turquie	2010	725
5406	La Turquie	2009	690
5407	La Turquie	2008	590
5408	La Turquie	2006	590
5409	Chateau D'Ampuis	2011	195
5410	Chateau D'Ampuis	2010	195
5411	Chateau D'Ampuis	2009	195
5412	Chateau D'Ampuis	2008	185
5413	Chateau D'Ampuis	1996	145

NORTH

5500	Cote Rotie, Pierre Gaillard, Les Ruchets	1999	99
5503	Cornas, Domaine Alain Vogue	1999	70
5504	Hermitage, E. Guigal, Ex - Voto	2006	525
5505	Hermitage, Jean Louis Chave	2005	450
5506	Hermitage, Jean Louis Chave	2003	450
5507	Hermitage, Jean Louis Chave	2002	390
5509	Hermitage, Jean Louis Chave	2000	380
5510	Hermitage, Ferraton Pere & Fils, Les Miaux	2000	75
5511	Saint Joseph, E. Guigal, Vigna de la Hospice	2012	165
5512	Saint Joseph, E. Guigal, Vigna de la Hospice	2011	180
5513	Saint Joseph, Jean Louis Chave, Offerus	1999	69

CHATEAUNEUF - DU - PAPE

5600	Chateau du Beucastel	2012	160
5601	Domaine de la Vielle Julienne	2011	90
5602	Font du Loup	2011	58
5603	Domaine de la Vielle Julienne, Les Hauts Lieux	2011	125
5604	Chateau du Pegau	2010	125
5605	Chateau du Beucastel	2000	105
5607	Chateau Rayas	2007	295
5608	Chateau Rayas	2000	160
5609	Chateau Rayas, Pignan	2000	100
5610	Chateau Rayas	1999	125
5611	Chateau Rayas, Pignan	1997	225
5612	Chateau Rayas	1997	125

OTHER FRENCH

5613	Bandol, Hecht & Bannier	2009	49
5614	Bandol, Chateau Vannieres	2009	69

BAROLO

5700	Angelo Germano	2010	75
5701	Giuseppe Rinaldi, Canubi	2005	140
5703	Fontanazza, Marengo	2001	170
5705	Giuseppe Rinaldi, Brunato	2000	180

BARBARESCO

5706	Fontanabianca, Sori Burdin	2007	110
5707	Produttori del Barbaresco, Rio Sordo	2005	99
5709	Moccagatta, Bric Ballin	2004	95
5710	Pelissero, Vanotu	2000	125
5715	Pelissero	1997	110
5715	Dante Rivetti, Brico de Neuiss	1990	160
5718	Gaja, Sori San Lorenzo	2000	395
5721	Gaja, Sori Teldin	1997	395

NORTHERN ITALY

5723	Croatina, Le Piane, Colline Novaresi	2008	69
5725	Croatina, Le Piane, Colline Novaresi	2007	69
5727	Nebiolo, Le Piane, Boca	2004	75
5729	Pignolo, Moschioni, Friuli Venezia	2003	180
5732	Barbera D'Asti, Quorum	2000	130

SUPERTUSCANS

5735	Villa Toscana, Antinori, Toscana	2010	50
5736	Guidalberto, Tenuta San Guido, Bolgheri	2008	79
5737	Arcanum, Tenuta di Arceno, Toscana	2007	135
5738	Arcanum, Tenuta di Arceno, Toscana	2006	135
5740	Aione, Podere Casina, Toscana	2004	69
5745	Fontodi, Flaccianello de la Pieve, Colli Della Toscana Centrale	2000	110
5746	I Sodi di San Niccolo, Castellare, Toscana	2000	125
5749	Solare, Cappanelle, Toscana	1996	120
5751	Sassicaia, Tenuta San Guido, Bolgheri	2005	315
5753	Sassicaia, Tenuta San Guido, Bolgheri	2003	315

CENTRAL ITALY

5754	Chianti Clasico, Tenuta di Lilliano, Tuscany	2013	59
5756	Chianti Clasico Riserva, Marchese Antinori, Tuscany	2010	69
5757	Chianti Clasico, Castello di Uzzano, Tuscany	2010	62
5758	Brunello di Montalcino, Cerbaiona, Tuscany	2009	275
5760	Chianti Clasico Riserva, Felsina, Berardenga, Tuscany	2007	79
5761	Montepulciano, Oasi Degli Angeli, Kurni, Marche	2005	140
5762	Chianti Clasico Riserva, Tenuta di Nozzole, La Forra, Tuscany	2004	79

SOUTHERN ITALY

5768	Aglianico, Azienda Agricola De Conciliis, Campania	2009	59
5769	Lacrima di Morro D'Alba, Luigi Guisti, Rubajano	2008	59
5770	Terre del Volturno, Nanni Cope, Campania	2008	75
5771	Nerello Mascalese, Graci, Quota 600, Etna Rosso, Sicili	2008	75
5773	Aglianico d'Irpinia, I Favatti, Terzotratto, Campania	2003	70
5775	Magliocco, Terre di Balbia, Balbium, Calabria	2002	59

RIOJA

5800	Bodegas Artevino, Orbin, Crianza	2007	70
5801	Bodegas Roda, Cirsion, Crianza	2003	285
5802	Viña Olabarri, Gran Reserva	2001	55
5803	Contino, Viña del Olivo	2001	150
5805	La Rioja Alta, Gran Reserva	1995	295
5806	La Rioja Alta, Gran Reserva	1994	290
5807	La Rioja Alta, Gran Reserva	1985	290

PRIORAT

5808	Clos Mogador	2008	140
5809	Clos Mogador	2007	140
5810	Clos Figuera	2007	130
5811	Clos Martinet	2004	170
5812	Clos Figueras	2004	140
5813	Clos Erasmus	2004	185
5814	Alvaro Palacios, Finca Dolfi	2003	130
5815	Mas Doix	2002	130
5817	Alvaro Palacios, L'Ermita	2000	425

THE REST OF SPAIN & IBERIAN PENINSULA

5818	Garnacha, Bodegas Alto Moncayo, Campo de Borja	2009	79
5819	Garnacha, Bodegas Alto Moncayo, Campo de Borja	2008	180
5820	Garnacha, Bodegas Alto Moncayo, Campo de Borja	2006	180
5821	Montsant, Clos Pissarra, Artisan, Catalunya	2008	54
5822	Montsant, Rene Barbier, El Espectacle de Montsant	2007	145
5824	Montsant, Arrels, Clos Oblidat, Sangre de Garnatxa, Catalunya	2006	54
5825	Ribera del Duero, Bodegas Lleiroso, Reserva, Castilla y Leon	2006	62
5826	Cabernet Sauvignon Blend, Bodega EL Nido, Jumilla	2005	180
5827	Ribeira Sacra, Dominio do Bibe, Lalama, Galicia	2004	69
5828	Bierzo, Bodega Paixar, Galicia	2003	120
5829	Ribera del Duero, Hacienda Monasterio, Castilla y Leon	2001	80
5830	Abbadia Retuerta, Cuveè Lapsus, Sardon del Duero	1997	180
5831	Pintas Character, Wine & Soul, Douro Valley, Portugal	2010	59
5832	Quinta do Vallado, Reserva, Douro Valley, Portugal	2004	75

5833	Alion	2011	155
5834	Alion	2009	155
5835	Alion	2007	155
5836	Alion	2004	155
5837	Valbuena	2009	255
5838	Valbuena	2008	255
5839	Valbuena	2007	255
5840	Valbuena	2006	255
5841	Valbuena	2002	265
5844	Unico	2004	600
5845	Unico	2003	600
5846	Unico	2002	600
5848	Unico	1999	570
5849	Unico	1996	925
5851	Unico	1994	975
5852	Unico	1989	670

AUSTRALIA

SHIRAZ

5900	Amon-Ra, Ben Glaetzer, Barossa Valley	2010	125
5901	Two Hands, Angel Share, Barossa Valley	2006	40
5902	Two Hands, Max Garden, Barossa Valley	2005	80
5904	The Octavius, Yalumba, Barossa Valley	2003	95
5905	Clarendon Hills, Bookman Vineyard, McLaren Vale	2003	125
5907	Mollydooker, Blue Eyed Boy, South Australia	2012	75
5908	Mollydooker, The Boxer South Australia	2012	59

OTHER AUSTRALIAN VARIETALS

5911	Grenache, Clarendon Hills, Kangarilla Vineyard, McLaren Vale	2003	99
5912	Merlot, Mollydooker, Scooter, South Australia	2010	59

5913	The Gask, MT. McKenzie, Eden Valley	2005	95
5915	The Pict, Old Vine Mataro From Quarry Block of Materne Vineyard	2005	195
5914	The Celts, From 222 vines, Estate Vineyard, Barossa Valley	2004	140
5917	The Factor, A Blend of Old Vines From Barossa Valley Vineyards	2004	155
5918	The Descendant, 8% Viognier Cofermented With Shiraz, All Estate Vineyard	2004	155
5919	Les Amis, Very Old Vine Grenache From a Dry Farmed Vineyard	2003	195
5920	Run Rig, 160 Year Old Vine Shiraz With a Small Addition of Viognier	2003	280
5922	The Factor, A Blend of Old Vines From Barossa Valley Vineyards	2002	145
5923	The Descendant, 8% Viognier Co-fermented With Shiraz, Estate Vineyard	2002	145
5924	The Struie, Barossa & Eden Valley Blend	2001	85

LATIN AMERICA

5925	Pinot Noir, Bodega Chacra, Barda, Patagonia, Argentina	2012	75
5926	Malbec Blend, Amancaya, Gran Reserva, Mendoza, Argentina	2011	47
5927	Malbec Blend, Palo Domingo, Salta, Argentina	2010	59
5928	Carmenere Blend, Casa Lapostolle, Clos Apalta, Colchagua, Chile	2008	100
5930	Pinot Noir, Bodega Chacra, Treinta y Dos, Patagonia, Argentina	2007	99
5931	Malbec, Catena Zapata, Adrianna Vineyard, Mendoza, Argentina	2007	125
5935	Cabernet Blend, Don Maximiano Errazuriz, Aconcagua Valley, Chile	2006	99
5936	Cabernet Blend, Almaviva, Puente Alto, Maipo Valley, Chile	2006	99
5937	Malbec Blend, Palo Domingo, Salta, Argentina	2002	99
5938	Malbec, Bodega Weinnert, Estrella, Mendoza, Argentina	1977	225
5939	Tempranillo Blend, Duetto, Santo Tomas, Valle de Guadalupe, Mexico	2007	164
5940	Merlot Blend, Tinta, Santo Tomas, Valle de Guadalupe, Mexico	2011	72
5941	Syrah Blend, Baron Balche, Valle de Guadalupe, Mexico	2010	106

HALF BOTTLES SPARKLING

6000	Cava Rose, Raventos, Conca del rui Anoia	NV	40
6001	Champagne, Bruno Paillard, Premier Cru	NV	75

HALF BOTTLES WHITE

6002	Sauvignon Blanc, Hall, Napa Valley, California	2014	45
6003	Pinot Blanc, Robert Sinskey Vineyards, Los Carneros, California	2012	50
6004	Viognier, Miner, Napa Valley, California	2013	30
6005	Chardonnay, Domaine De Fuissacus, Pouilly-Fuisse, Burgundy	2009	75

HALF BOTTLES RED

6009	Pomerol, Chateau Plince, Bordeaux, France	2001	85
6010	Araujo, Syrah, Calistoga	2000	75
6011	Araujo, Eisele Vineyard, Calistoga	2000	100
6012	Araujo, Eisele Vineyard, Calistoga	1999	120
6013	Araujo, Eisele Vineyard, Calistoga	1998	120
6014	Ridge, Montebello, Santa Cruz	1999	99

6100	Nicolas Feuillate, Brut	NV	135
6101	Cardonnay, Kistler, Trenton Roadhouse, Sonoma Coast, California	2012	350
6102	Cuvee Mysterieuse, Clos Saron, Sierra Foothills, California	NV	125
6128	Orion, Sean Thackrey, Rossi Vineyard, St Helena, Napa Valley	2013	210
6103	Pinot Noir, Kistler, Sonoma Coast, California	2012	350
6104	Ribera del Duero, Vega Sicilia, Alion, Castilla y Leon, Spain	2011	325
6105	Cabernet Sauvignon, Silver Oak, Alexander Valley, California	2010	275
6106	Cabernet Sauvignon, Silver Oak, Alexander Valley, California	2009	275
6108	Cabernet Sauvignon, Moraga Vineyard, Bel Air, California	2007	300
6109	Chateau Grand Puy Lacoste, Pauillac, Bordeaux, France	2005	300
6110	Cabernet Sauvignon, Moraga Vineyard, Bel Air, California	2005	340
6111	Supertuscan, Ornellaia, Antinori, Bolgheri, Italy	2003	400
6112	Cabernet Sauvignon, Staglin, Napa Valley, California	2002	325
6113	Cabernet Sauvignon, Moraga Vineyard, Bel Air, California	2001	340
6114	Pomerol, Chateau Beauregard, Bordeaux, France	2000	145
6115	Pauillac, Chateau Pichon Longeville Baron, Bordeaux, France	2000	375
6116	Margaux, Chateau D'Issan, Bordeaux, France	2000	175
6118	Margaux, Chateau Rauzan Gassies, Bordeaux, France	2000	225
6119	Margaux, Chateau Prieure Lichine, Bordeaux, France	2000	225
6120	St Julien, Chateau Gruaud Larose, Bordeaux, France	2000	360
6121	Cabernet Sauvignon, Merus, Napa Valley, California	2000	395
6122	Pomerol, Chateau Petit Village, Bordeaux, France	1999	190
6123	Meritage, Cuvee Kemiji & Portay, Miura Vineyard, Napa Valley	2010	145
6125	Barbaresco, Gaja, Sori Teldin, Piedmont, Italy	1989	650
6126	Cabernet Sauvignon, Grace Family, Napa Valley, California	1989	950
6127	Hermitage, Paul Jaboulet Aine, La Chapelle, Rhone Valley, France	1988	400

JEROBOAM

6200	Cabernet Sauvignon, Silver Oak, Napa Valley, California	2010	690
6201	Cabernet Sauvignon, Silver Oak, Napa Valley, California	2008	750
6202	St Emillion, Chateau Cheval Blanc, Bordeaux, France	2001	900

6300	Sauternes, Domaine de Monteils, Bordeaux, France (375)	2009	45
6301	Sauternes, Chateau Suiduiraut, Bordeaux, France (750)	2005	99
6302	Sauternes, Chateau d'Yquem, Bordeaux, France (750)	2002	595
6303	Sauternes, Chateau d'Yquem, Bordeaux, France (375)	2001	375
6304	Sauternes, Chateau d'Yquem, Bordeaux, France (750)	2000	750
6305	Sauternes, Chateau d'Yquem, Bordeaux, France (375)	1997	300
6306	Gewurztraminer, Zind Humbrecht, Clos Saint Urbain, Grand Cru, Alsace	1994	150
6307	Scheurebe, Alois Kracher, Trockenbeerenauslese #3, Austria (375)	1995	99
6308	Scheurebe, Alois Kracher, Trockenbeerenauslese #6, Austria (375)	1995	99
6309	Grand Cuvee, Alois Kracher, Trockenbeerenauslese #12, Austria (375)	1995	99
6310	Chardonnay, Alois Kracher, Trockenbeerenauslese #7, Austria (375)	1999	99
6311	Muller - Thurgau, Bert Simon, Beerenauslese, Mosel, Germany	2003	49
6312	Riesling, Weingut Gunderloch, Beerenauslese, Rheinhessen, Germany	2001	125
6313	Tokay, Oremus, 5 Puttonyos, Hungary	2005	105
6314	Muscat, Marryvale, Antigua, Napa Valley, California	MV	59
6315	Torcolato, Maculan, Veneto, Italy	2006	69
6316	Riesling, Inneskillin, Niagara, Canada	2002	90
6317	Picolit, Azienda Agricola Moschioni, Friuli, Italy (500)	2000	145
6318	Grenache, Dolc de L'Obac, Priorat, Catalunya	1999	110